

GENERATOR(for 100A Type) INSPECTION

PROCEDURE

1. INSPECT GENERATOR WITH CLUTCH PULLEY

- a. Hold the center of the generator with clutch pulley, and confirm that the outer ring turns counterclockwise and does not turn clockwise.

OK

The outer ring turns counterclockwise and does not turn clockwise.

If the result is not as specified, replace the generator with clutch pulley.

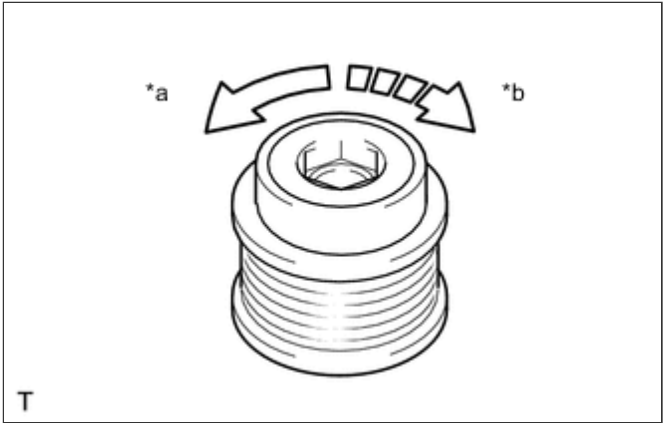

*a	Free
*b	Lock

2. INSPECT GENERATOR BRUSH HOLDER ASSEMBLY

- a. Using a vernier caliper, measure the length of the exposed brushes.

Standard Exposed Length

9.5 to 11.5 mm (0.374 to 0.453 in.)

Minimum Exposed Length

4.5 mm (0.177 in.)

If the brush length is less than the minimum, replace the generator brush holder assembly.

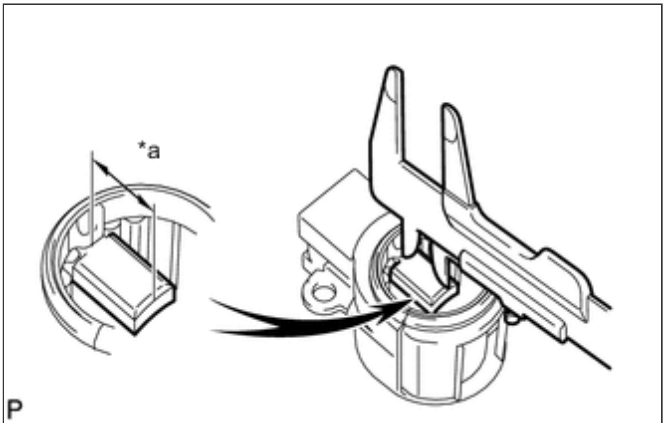

*a	Length
----	--------

3. INSPECT GENERATOR ROTOR ASSEMBLY

- a. Check the generator rotor assembly for an open circuit.
- i. Measure the resistance according to the value(s) in the table below.

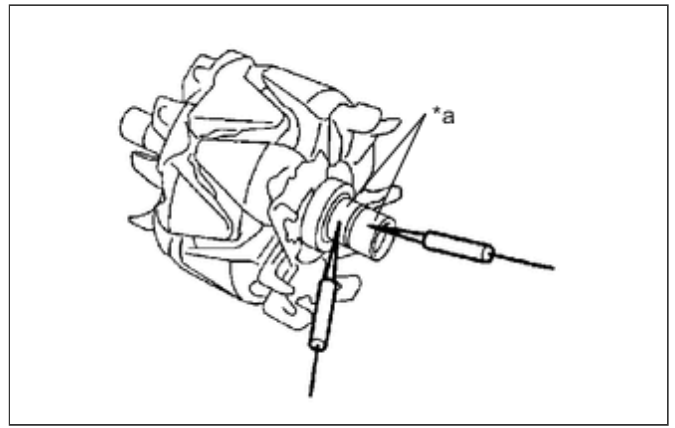

*a	Slip Ring
----	-----------

Standard Resistance

Tester Connection	Condition	Specified Condition
Slip ring - Slip ring	20°C (68°F)	1.8 to 2.2 Ω

If the result is not as specified, replace the generator rotor assembly.

b. Check the generator rotor assembly for a short to ground.

i. Measure the resistance according to the value(s) in the table below.

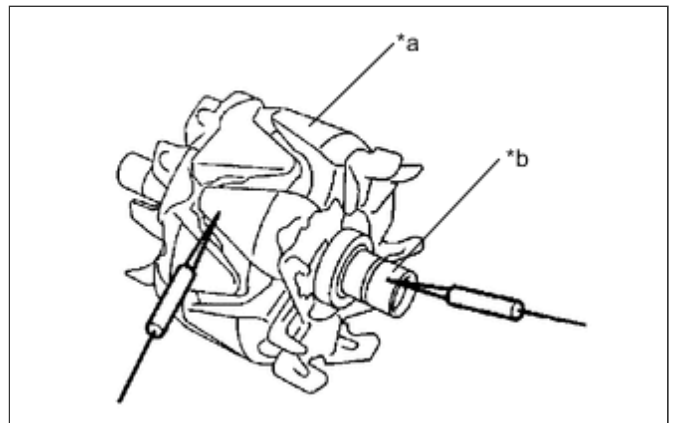

*a	Rotor
*b	Slip Ring

Standard Resistance

Tester Connection	Condition	Specified Condition
Slip ring - Rotor	Always	10 M Ω or higher

If the result is not as specified, replace the generator rotor assembly.

c. Check that the generator rotor bearing is not rough or worn and that it rotates smoothly.

If the bearing does not rotate smoothly, replace the generator rotor assembly.

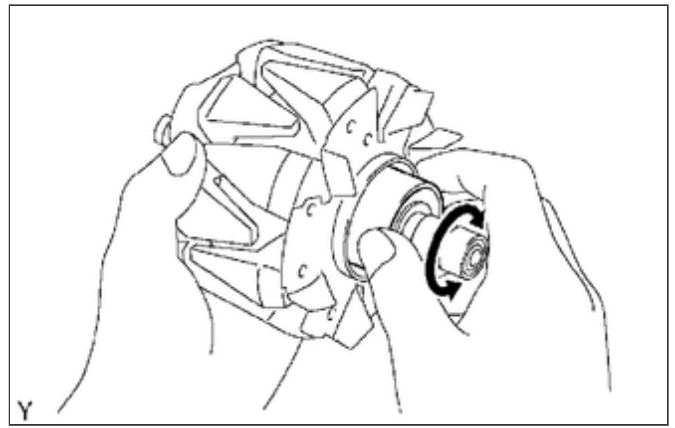

- d. Using a vernier caliper, measure the slip ring diameter.

Standard Diameter

14.2 to 14.8 mm (0.559 to 0.583 in.)

Minimum Diameter

14.0 mm (0.551 in.)

If the diameter is less than the minimum, replace the generator rotor assembly.

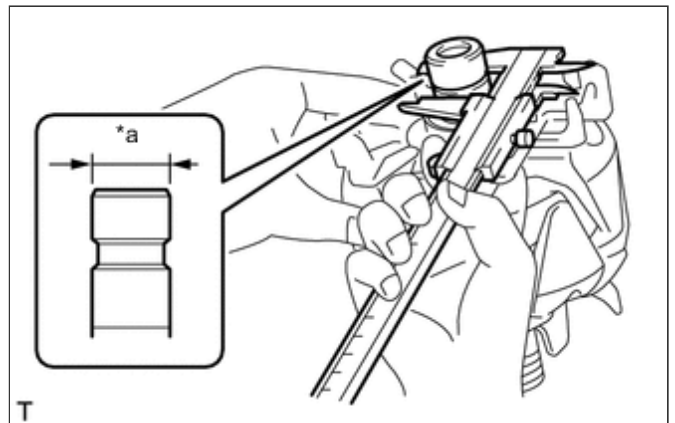

*a	Diameter
----	----------

- e. Check that the slip rings are not rough or scored.

If rough or scored, replace the generator rotor assembly.

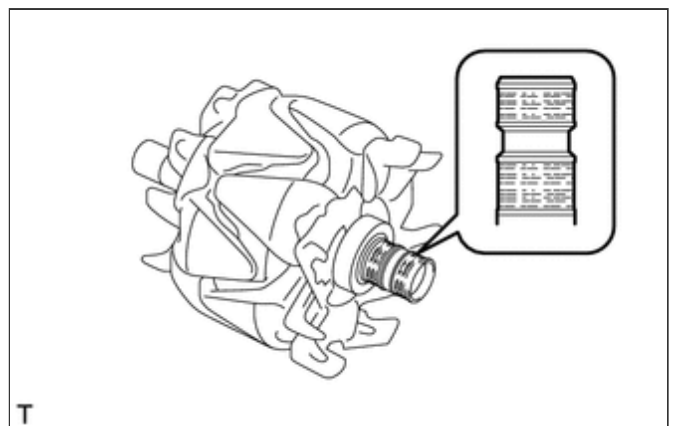

4. INSPECT GENERATOR ROTOR BEARING

- a. Check that the generator rotor bearing is not rough or worn and that it rotates smoothly.

If rough, worn or does not rotate smoothly, replace the generator rotor bearing.

